

Wall Mounting Sky Glass

Carefully read all the steps before starting.

Warnings and Cautions

- **You must use a professional installer to wall mount Sky Glass.**
- Please read the 'important safety and product information' leaflet before installing Sky Glass.
- Carefully read all the installation steps before starting.
- Take care at least two people are required to carry out the installation.
- To allow safe handling of the TV, ensure that there is sufficient space to move in front of and to the sides of the intended mounting location and that the area is clear of obstacles. (Typically, allow 1m each side of the template and 1.5m in front of the mounting location).
- Check your fixings match the wall type to which you are mounting, see section below for recommendations.
- If it's not fully secure, your Sky Glass could fall causing personal injury or even death, and damage to the TV and anything nearby.
- Sky Glass must be installed near a mains supply wall socket, which should be easily accessible. If the mains supply socket is hidden behind the TV panel then the socket must be recessed into the wall and a separate isolation switch fitted. The isolation switch must be easily accessible. This work must be carried out by a qualified electrician.
- Sky Glass is designed and intended to be mounted and/or installed only by a professional installer and to the fullest extent permissible under law Sky excludes all liability for any injury and/or damage caused by incorrect and/or non-professional installation or assembly.

TV weight without stand

- 43" 14kg
- 55" 23kg
- 65" 28kg

Wall mounting with a Sky bracket

To use the Sky bracket here's what you'll need:

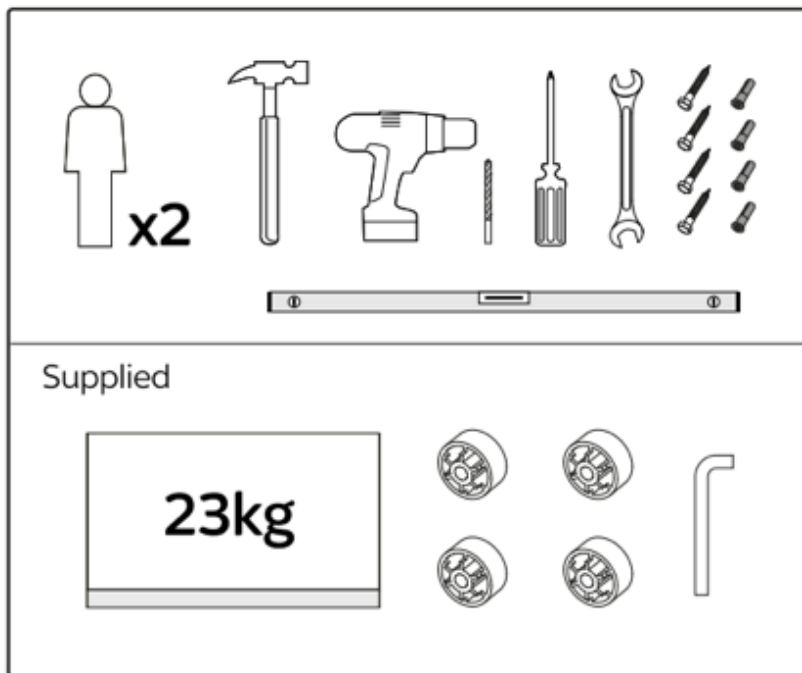

Additional kit you'll need:

- Drill and drill bit
- Screwdriver or spanner
- Hammer
- Spirit level
- Appropriate wall fixings

Check your wall type and fixings

Brick or dense concrete block wall
Hole size: 8mm
Hole depth: 55mm
High performance wall plug: 8mm x 40mm
Screw type: Steel coach screw
Screw dimension: 6mm x 70mm

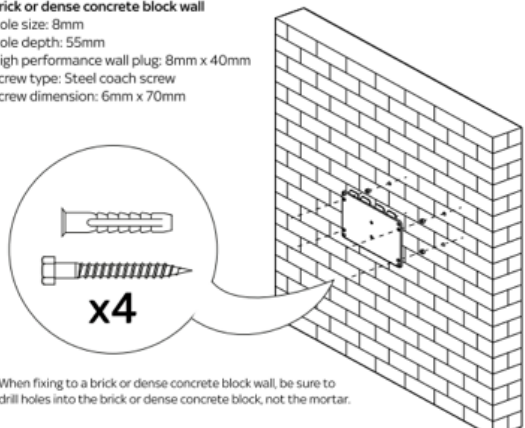

x4

When fixing to a brick or dense concrete block wall, be sure to drill holes into the brick or dense concrete block, not the mortar.

Aerated concrete block wall (3.6N)
Hole size: 10mm
Hole depth: 70mm
High performance wall plug: 10mm x 50mm
Screw type: Steel coach screw
Screw dimension: 8mm x 80mm

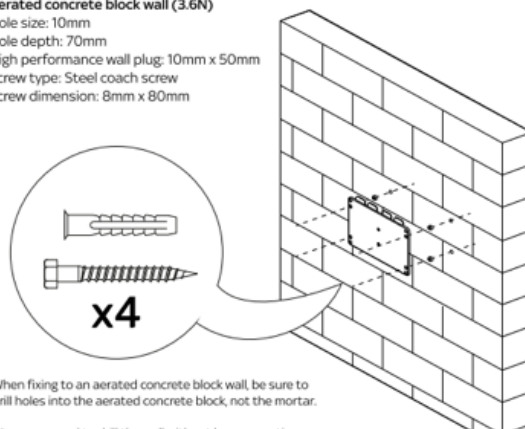

x4

When fixing to an aerated concrete block wall, be sure to drill holes into the aerated concrete block, not the mortar.
We recommend to drill the wall without hammer action.

Stud wall
Use specialist plasterboard fixings from a trusted supplier
Diameter: 20mm
Drill size: 20mm

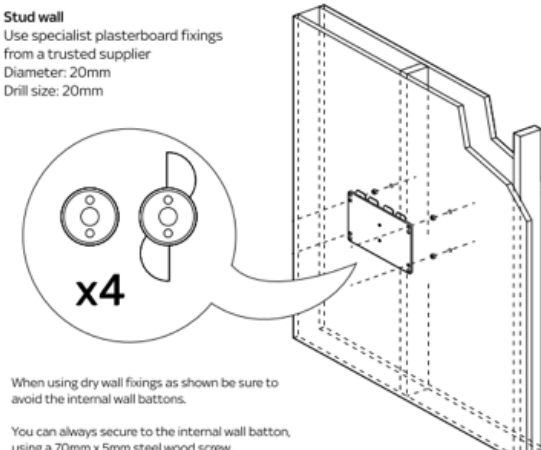

x4

When using dry wall fixings as shown be sure to avoid the internal wall battens.
You can always secure to the internal wall batten, using a 70mm x 5mm steel wood screw.

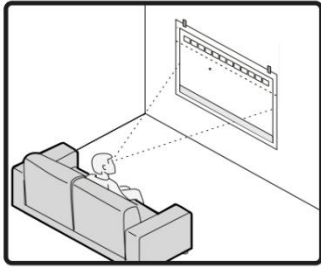

1. Attach this template to the wall as if it were your Sky Glass, use a spirit level to check it's flat. Check that your eyeline is in the centre.

If your Sky Glass doesn't have a stand fitted, you can go straight to step six.

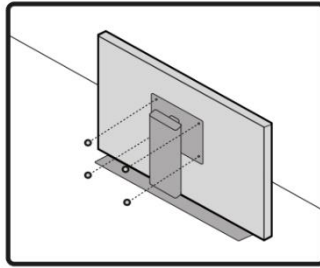

2. Grab the Allen key provided and undo the four black screws in the rear cover.

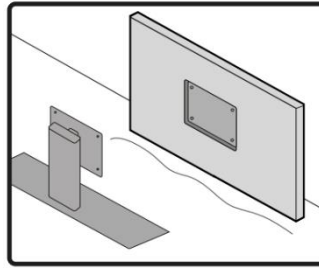

3. Carefully lift the TV off the stand and place it safely on a soft surface.

⚠ Warning - TV is heavy, two person lift required.

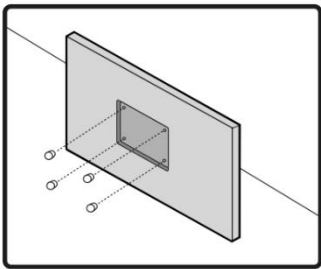

4. Remove the four white internal spacers from the back of the TV.

Keep safe for future use.

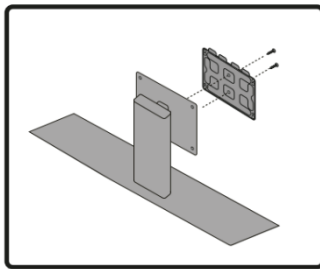

5. Take the wall mounting bracket off the stand by undoing the two screws. Set the bracket to one side as you'll need it in step seven.

Keep the rest of the stand safe for future use.

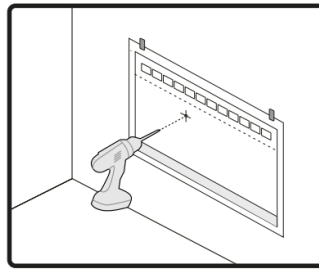

6. Drill the first hole into your wall as marked by the template. Then carefully remove the lower part of the template.

When removing the lower part of the template ensure the top part stays attached to the wall.

⚠ Caution: Before starting check your wall type, fixings and hole depth.

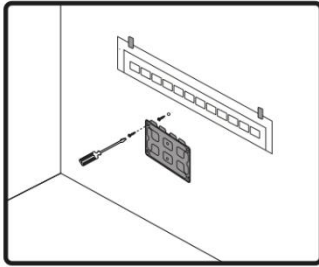

7. Loosely screw the bracket into the hole you just made using one of your fixings.

Ensure you fit your screw through the 9mm hole, not the larger hole above.

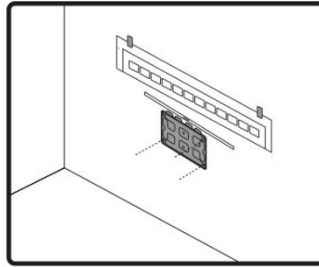

8. Use a spirit level to check that the bracket is level before marking the three remaining holes.

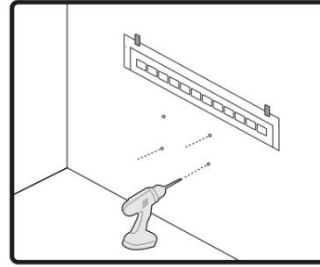

9. Remove the bracket and drill the three remaining holes.

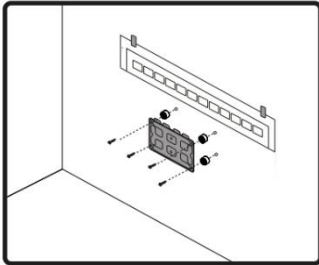

10. Secure the bracket to the wall using your fixings. Remember to fit the four spacers supplied between the wall and bracket as shown.

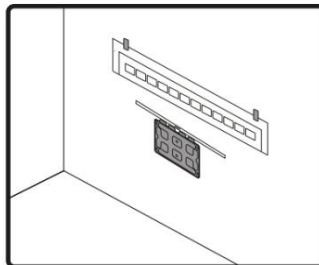

11. Using a spirit level, check the bracket is level. Adjust if necessary.

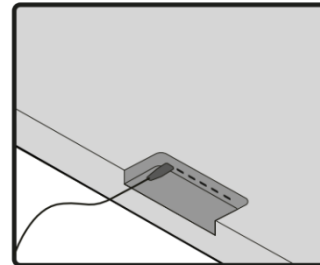

12. Plug the power cable into your Sky Glass along with any other cables you want e.g. HDMI. Do not plug the power cable into the mains just yet.

Watch out for trailing cables.

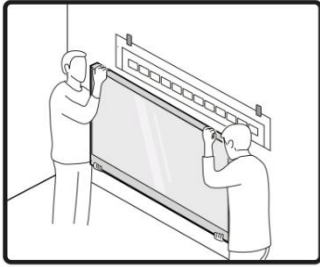

13. Carefully lift your Sky Glass and start to align it to the template.

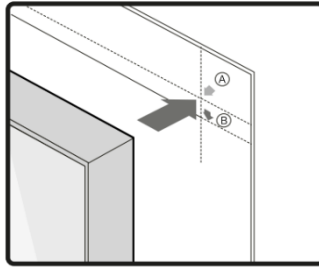

14. The top edge should be parallel to line (A).

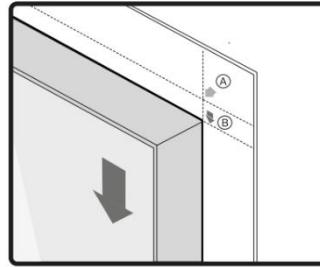

15. With your Sky Glass flat against the wall, lower it until the top edge lines up with (B). The wall mount should now be engaged.

Ensure the TV is securely aligned and attached to the wall mount bracket.

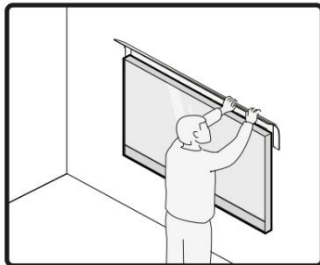

16. Remove remaining paper template carefully.

If you've plugged in any device cables at step twelve, connect them to your devices now.

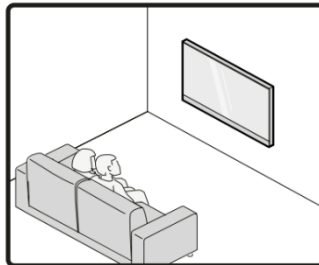

17. Plug in to the mains, then sit back and enjoy.

Wall mounting with a 3rd party bracket

- Your professional installer should make sure the wall bracket, screws and spacers are suitable for the size, length and weight of your Sky Glass and compatible with the surface to which the Sky Glass is to be affixed.
- Your professional installer should also ensure that the surface to which the Sky Glass and any bracket and fixings are to be attached is suitable and can withstand its load. If the mounting and/or installation work is not carried out in the correct manner, there is a risk of injury and/or damage to your TV and/or other objects.

You may need to remove the stand from the back of your TV to access the VESA screw mounting holes.



1. Using the Allen key provided, undo and remove the four screws on the back cover.



2. Carefully lift the TV off the stand and place it screen up on a soft surface (you will need two people).

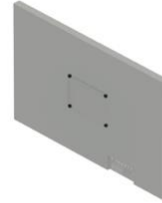

3. Remove the four white internal spacers from the back of the TV.

Follow your 3rd party wall mounting bracket setup instructions.